



NMLGN

- flat dome
- for light elements
- hygienic design
- Protection class IP69K
- Mounting hole 22.3 mm

Data

Ordering data

Product type description	NMLGN
Article number (order number)	101174521
EAN (European Article Number)	4250116201402
eCl@ss number, version 12.0	27-37-12-11
eCl@ss number, version 11.0	27-37-12-11
eCl@ss number, version 9.0	27-37-12-11
ETIM number, version 7.0	EC000223
ETIM number, version 6.0	EC000223

Approvals - Standards

Certificates	BG cULus
--------------	-------------

General data

Standards	EN IEC 60947-5-1 EN IEC 60947-1
Versions	Indicator lights
Design	Flat

Installation conditions (mechanical)	arbitrarily
Sealing type	Membrane Lip gaskets Form seals
Material of the dome	PA (12)
Material of the front ring	ABS, chrome-plated
Colour of the operating element	Green
Colour of the front ring	Silver
Gross weight	30 g

General data - Features

Illuminable	Yes
Mounting flange	Yes
Fully insulated	Yes

Mechanical data

Mounting	Mounting flange ELM
Tightening torque of the screw	0.6 Nm

Mechanical data - Dimensions

Diameter total	44.5 mm
Height of the dome	2 mm
Diameter of the dome	26 mm
Mounting diameter	22.3 mm
Thickness, of the front panel, minimum	1.5 mm
Thickness of the front panel, maximum	6 mm
Spacing	50 x 50 mm

Ambient conditions

Degree of protection	IP67 IP69K
----------------------	---------------

Ambient temperature -25 ... +80 °C

Resistance to shock 30 g / 18 ms

Status indication

Note (Integral System Diagnostics, status) for 24 VAC/DC

Scope of delivery

Note (scope of delivery, number and type) Mounting flange ELM is included in delivery

Ordering code

Product type description:

-

(1)DT(8)(2)	Pushbutton
(1)DM(2)	Pushbutton with diaphragm for dust protection
(1)DL(8)(2)	Illuminated pushbutton
(1)DLM(2)	Illuminated pushbutton with diaphragm for dust protection
(1)ML(2)	Indicator light with flat collar
(1)MLH(2)	Indicator light with high collar
(1)DP(3)(8)(2)	Mushroom head impact button without latching
(1)DTP(3)(8)(2)	Mushroom head impact button without latching (only N-programm)
(1)DLP(3)(8)(2)	Mushroom head impact button illuminated, without latching (only N programme)
(1)DRR(3)(8)(2)	Mushroom head impact button with latching, unlock by turning and pulling (pulling only in N programme)
(1)DRZ(3)(8)(2)	Mushroom head impact button with latching, unlock by pulling
(1)WS21(4)(5)	Selector switch with 2 positions:
(1)WT21(4)(5)	Selector switch with 1 momentary position
(1)WS32(4)(5)	Selector switch with 3 maintained positions
(1)WT32(4)(5)	Wahlschalter mit 2 Taststellungen

(1)WST32(4)(5)	Selector switch: switching, latching
(1)WTS32(4)(5)	Selector switch: latching, switching
(1)SS21S(4)(5)	Key-operated selector switch with 2 maintained positions
(1)ST21S(4)(5)	Key-operated selector switch with 1 momentary position
(1)SS32S(4)(5)	Key-operated selector switch with 3 maintained positions
(1)ST32S(4)(5)	Key-operated selector switch with 2 momentary positions, left and right
(1)SST32S(4)(5)	Key-operated selector switch: switching, latching
(1)STS32S(4)(5)	Key-operated selector switch: latching, switching

B

Blanking plug

(1)

-	Command and signalling devices:
E	"E" program
N	"N" program
R	"R" program

(2)

-	Colour of button surface:
SW	Black
GB	Yellow
RT	Red
GN	Green
WS	White
BL	Blue
GR	Grey

(3)

-	Head diameter of mushroom head impact button 30 mm:
30	30 mm
35	35 mm

40	40 mm
42	42 mm
45	45 mm
50	50 mm
55	55 mm
70	70 mm

(4)

-	Toggle length in mm:
without	Short toggle
.1	Long toggle

(5)

-	Colour of toggle:
without	Grey
WS	White

(6)

-	Key-withdrawal position (3 positions):
1	Position left
2	Position middle
3	Position right

(7)

-	Key-withdrawal position (2 positions):
1	Position left
2	Position right

(8)

-	Colour of diaphragm (only N programme):
without	White
GR/	Black
BL/	Blue

Pictures

Product picture (catalogue individual photo)



ID: knml-f04

| 348.3 kB | .jpg | 352.778 x 316.794 mm - 1000 x 898 px - 72 dpi

| 36.7 kB | .png | 74.083 x 66.322 mm - 210 x 188 px - 72 dpi

| 60.1 kB | .jpg | 123.472 x 110.772 mm - 350 x 314 px - 72 dpi

Dimensional drawing basic component

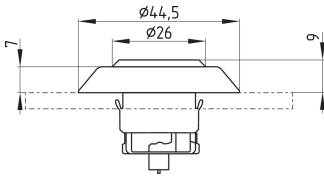

ID: knml-g01

| 19.7 kB | .cdr |

| 2.2 kB | .png | 74.083 x 39.158 mm - 210 x 111 px - 72 dpi

| 64.3 kB | .jpg | 352.778 x 186.267 mm - 1000 x 528 px - 72 dpi

Schmersal Ltd., Sparrowhawk Close, WR14 1GL Malvern

The details and data referred to have been carefully checked. Images may diverge from original. Further technical data can be found in the manual. Technical amendments and errors possible.

Generated on: 24/05/2024, 14:04