



## T4VH 336-02ZH-M20

- slim design
- 1 Cable entry M 20 x 1.5
- Design to EN 50041
- Lever angle adjustable in 10° steps
- Thermoplastic enclosure
- Double-insulated
- Good resistance to oil and petroleum spirit
- Wide range of alternative actuators
- Actuator heads can be repositioned by 4 x 90°

## Data

### Ordering data

|                               |                   |
|-------------------------------|-------------------|
| Product type description      | T4VH 336-02ZH-M20 |
| Article number (order number) | 151159163         |
| eCl@ss number, version 12.0   | 27-27-26-01       |
| eCl@ss number, version 11.0   | 27-27-26-01       |
| eCl@ss number, version 9.0    | 27-27-26-01       |
| ETIM number, version 7.0      | EC000030          |
| ETIM number, version 6.0      | EC000030          |

### Approvals - Standards

|              |              |
|--------------|--------------|
| Certificates | cULus<br>CCC |
|--------------|--------------|

### General data

|                           |                          |
|---------------------------|--------------------------|
| Housing construction form | Norm construction design |
| Actuator type to EN 50041 | A                        |

|                  |                                 |
|------------------|---------------------------------|
| Housing material | Plastic, glass-fibre-reinforced |
| Lever material   | Metal film                      |
| Gross weight     | 183 g                           |

## General data - Features

|                           |     |
|---------------------------|-----|
| Safety functions          | Yes |
| Number of safety contacts | 2   |

## Safety classification

|              |   |
|--------------|---|
| Standards    | BG-GS-ET-15<br>EN ISO 13849-1<br>EN IEC 60947-5-1 |
| Mission time | 20 Year(s)  |

## Safety classification - Safety outputs

|   |                       |
|---|-----------------------|
| B <sub>10D</sub> Normally-closed contact (NC) | 20,000,000 Operations |
|---|-----------------------|

## Mechanical data

|                           |   |
|---------------------------|---|
| Actuating element         | Roller lever  |
| Roller material           | Plastic   |
| Mechanical life, minimum  | 30,000,000 Operations                                   |
| Actuating speed, maximum  | 2.5 m/s   |
| Note (Actuating speed)    | Actuating speed with actuating angle 30° to switch axis |
| Note (Switchover time)    | Switchover time in accordance with actuating speed      |
| Actuating torque, minimum | 0.3 Nm  |

## Mechanical data - Connection technique

|                        |                           |
|------------------------|---------------------------|
| Termination            | Screw terminals M20 x 1.5 |
| Cable section, minimum | 0.75 mm <sup>2</sup>      |
| Cable section, maximum | 2.5 mm <sup>2</sup>       |

Note (Cable section)

All indications including the conductor ferrules.

### Mechanical data - Dimensions

|                  |          |
|------------------|----------|
| Length of sensor | 60.5 mm  |
| Width of sensor  | 40.5 mm  |
| Height of sensor | 129.5 mm |

### Ambient conditions

|                      |                |
|----------------------|----------------|
| Degree of protection | IP65<br>IP67   |
| Ambient temperature  | -30 ... +80 °C |

### Ambient conditions - Insulation values

|   |       |
|---|-------|
| Rated insulation voltage $U_i$            | 500 V |
| Rated impulse withstand voltage $U_{imp}$ | 6 kV  |

### Electrical data

|                                      |                                     |
|--------------------------------------|-------------------------------------|
| Thermal test current                 | 10 A                                |
| Required rated short-circuit current | 1,000 A                             |
| Utilisation category AC-15           | 230 VAC                             |
| Utilisation category AC-15           | 4 A                                 |
| Utilisation category DC-13           | 24 VDC                              |
| Utilisation category DC-13           | 4 A                                 |
| Switching element                    | Opener (NC)                         |
| Switching principle                  | Slow action with staggered contacts |
| Bounce duration, maximum             | 2 ms                                |
| Switching frequency                  | 5,000 /h                            |
| Material of the contacts, electrical | Silver                              |

### Ordering code

Product type description:

(1)(2) 336-(3)(4)-(5)-(6)-(7)-(8)-(9)

|              |   |
|--------------|---|
| (1)          |   |
| <b>Z</b>     | Snap action   |
| <b>T</b>     | Slow action (not for AF/S)  |
| (2)          |   |
| <b>S</b>     | Plunger S   |
| <b>R</b>     | Roller plunger R  |
| <b>H</b>     | Roller lever H  |
| <b>10H</b>   | Rod lever 10H   |
| <b>7H</b>    | Roller lever 7H   |
| <b>1K</b>    | Offset roller lever 1K  |
| <b>3K</b>    | Angle roller lever 3K   |
| <b>RMS</b>   | Brass roller  |
| (3)          |   |
| <b>11</b>    | 1 NO contacts/1 NC contact  |
| <b>02</b>    | 2 NC contact  |
| <b>20</b>    | 2 NO contacts, (switches with 2 NO contacts are not suitable for safety applications) |
| <b>01/01</b> | 1 NC contact left / 1 NC contact right  |
| (4)          |   |
| <b>Y</b>     | IP 65   |
| <b>Z</b>     | IP 67   |
| (5)          |   |
| <b>R</b>     | without latching<br>with latching   |
| (6)          |   |
| <b>H</b>     | Slow action with staggered contacts   |
| <b>UE</b>    | Slow action with overlapping contacts   |

(7)

|                |                             |
|----------------|-----------------------------|
| <b>without</b> | Cable entry M20             |
| <b>NPT</b>     | Cable entry NPT 1/2"        |
| <b>ST</b>      | M12 connector with A-coding |
| <b>ST-2310</b> | M12 connector with B-coding |

(8)

|             |  |
|-------------|--|
| <b>2138</b> | Roller lever 7H for position switches with safety function |
|-------------|--|

(9)

|             |                      |
|-------------|----------------------|
| <b>1637</b> | Gold-plated contacts |
|-------------|----------------------|

## Pictures

### Product picture (catalogue individual photo)



ID: k336hf01

| 697.8 kB | .jpg | 352.778 x 752.122 mm - 1000 x 2132 px - 72 dpi

| 87.5 kB | .png | 74.083 x 157.692 mm - 210 x 447 px - 72 dpi

| 30.2 kB | .jpg | 57.856 x 123.472 mm - 164 x 350 px - 72 dpi

### Dimensional drawing basic component

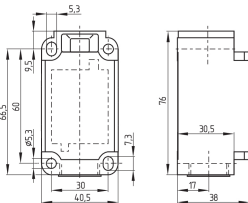

ID: 1-336g01

| 51.4 kB | .cdr |

| 4.1 kB | .png | 74.083 x 51.506 mm - 210 x 146 px - 72 dpi

| 107.0 kB | .jpg | 352.778 x 245.181 mm - 1000 x 695 px - 72 dpi

### Dimensional drawing actuator

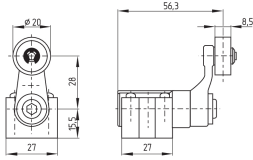

ID: 1h336g01

| 65.6 kB | .cdr |

| 4.1 kB | .png | 74.083 x 51.858 mm - 210 x 147 px - 72 dpi

| 84.5 kB | .jpg | 352.778 x 247.297 mm - 1000 x 701 px - 72 dpi

## Switch travel diagram

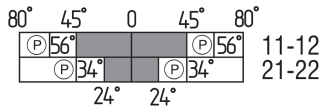

ID: kh335s14

| 34.2 kB | .cdr |

| 2.5 kB | .png | 74.083 x 24.694 mm - 210 x 70 px - 72 dpi

| 79.7 kB | .jpg | 352.778 x 117.122 mm - 1000 x 332 px - 72 dpi

## Diagram

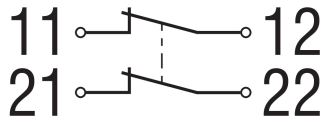

ID: k2o--k01

| 48.8 kB | .jpg | 352.778 x 125.236 mm - 1000 x 355 px - 72 dpi

| 2.3 kB | .png | 74.083 x 26.458 mm - 210 x 75 px - 72 dpi

Schmersal Ltd., Sparrowhawk Close, WR14 1GL Malvern

The details and data referred to have been carefully checked. Images may diverge from original. Further technical data can be found in the manual. Technical amendments and errors possible.

Generated on: 21/02/2024, 15:18